

# 51.2V 314AH

## BATTERY PACK SPECIFICATION



Battery Pack Specification  
电池组规格书

# SPECIFICATIONS

## Appearance And Interface



# PARAMETER

ITEMS	SPECIFICATIONS
Rated energy(kwh) (容量)	16KWH
Configuration. (装配)	1P 16S
Nominal Voltage(V) (标称电压)	51.2V
Working Voltage(V) (工作电压)	42V~58.4V
Nominal Capacity(Ah) (标称容量)	314Ah
Rated charge/discharge Current(A) (标准充放电电流)	100A/200A @25±2°C
Maximum charging current (最大持续充电电流)	200A @25±2°C
Maximum discharge current (最大持续放电电流)	200A @25±2°C
Working Temperature (工作温度)	0~40°C (Charge) 充电 -20~60°C (Discharge) 放电
Humidity(%) 湿度(%)	5~95%
Altitude Limited(m) 通讯距离(m)	0-3000m
Weight(Kg) 重量(Kg)	113kg±3kg
Dimension(mm) 尺寸(mm)	797*415*270mm
Storage temperature and humidity (存放温度/湿度)	-10°C~35°C (Within one month of storage) 存放一个月 25±2°C (Within three months of storage) 存放3个月 65%±20%RH
cycle life (循环使用寿命)	8000 cycles @25°C 50A Charge and discharge current 80%DOD
IP grade (防水等级)	IP20
Communication mode (通讯接口)	CAN&RS485

# CONNECTION DIAGRAM

## English ①

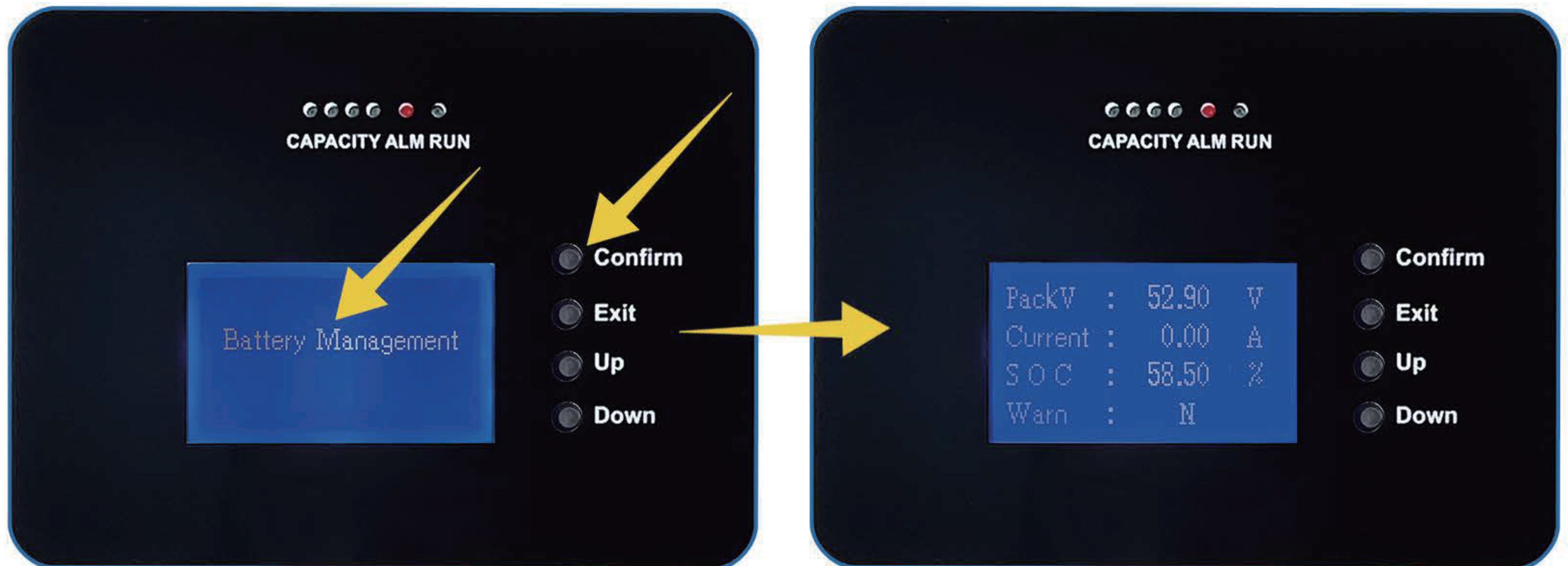

**1. Click "confirm" to enter the "Main menu"**

## 中文①



**1. 点击 "confirm" 进入 "主页面"**

# CONNECTION DIAGRAM

## English ②

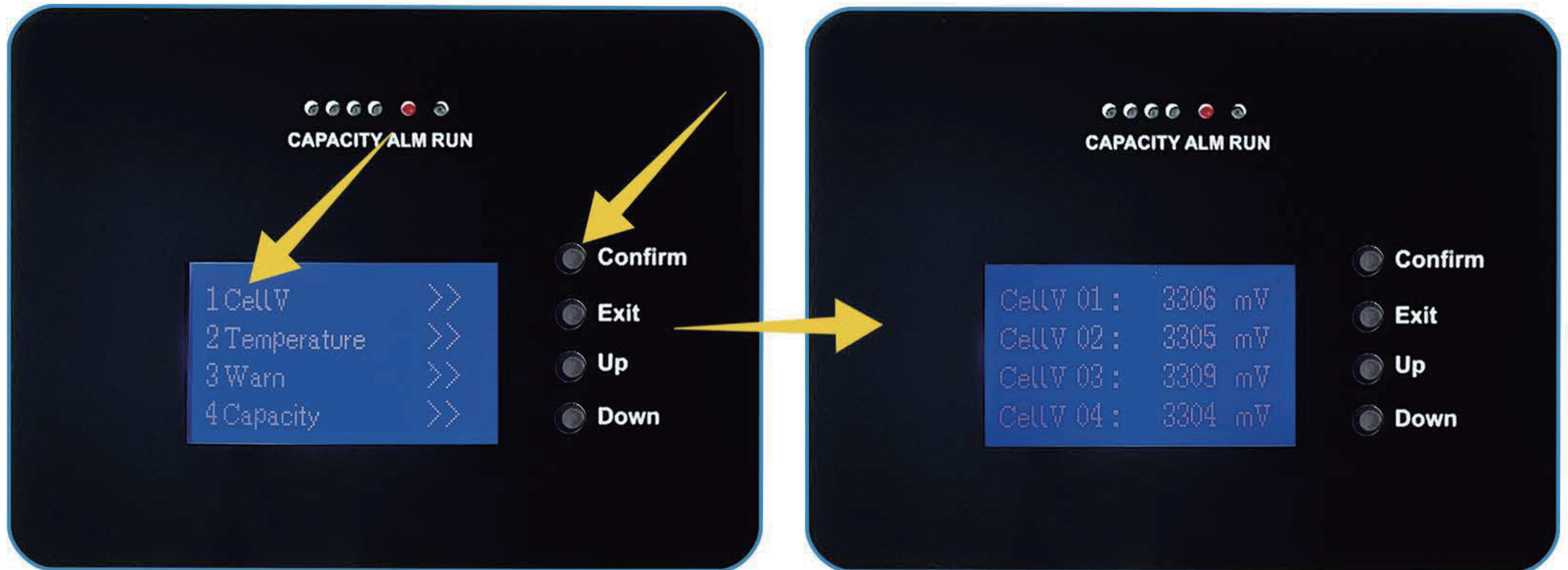

**2. Select "Voltage" and click "confirm" to enter**

## 中文②

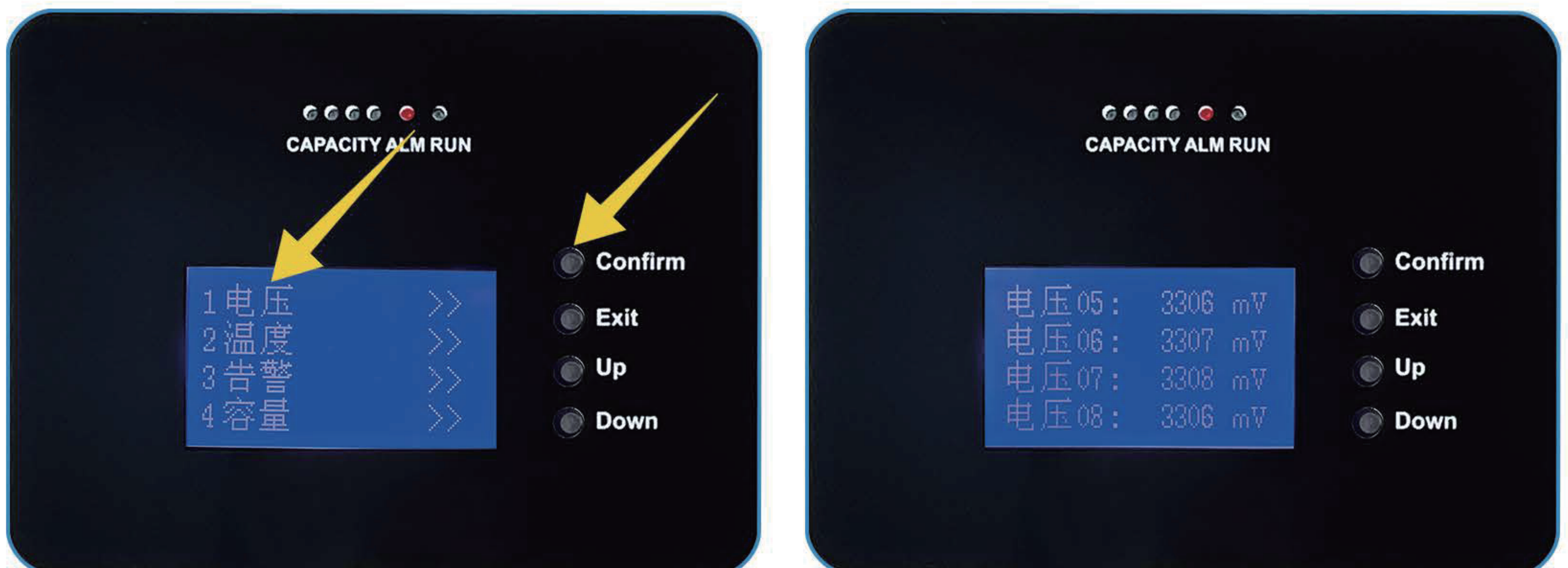

**2.选择“电压” 点击“confirm” 进入**

# CONNECTION DIAGRAM

## English ③

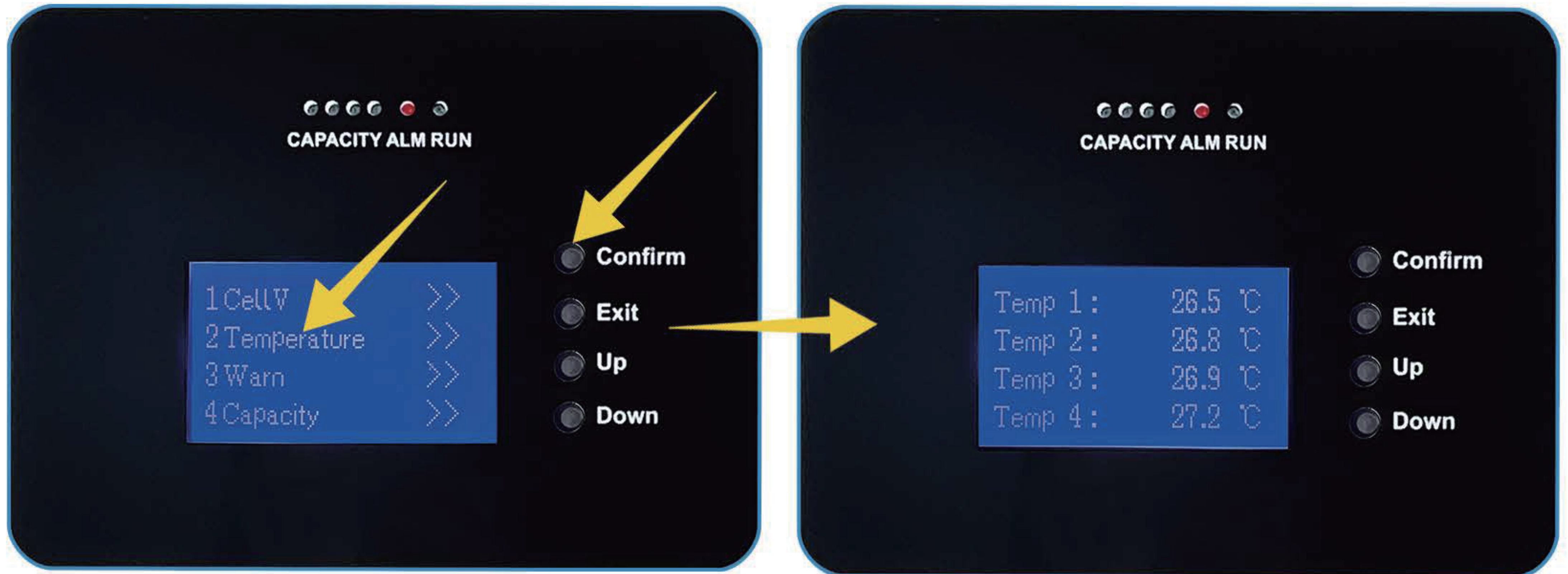

**3. Select "Temperature" and click "confirm" to enter**

## 中文 ③

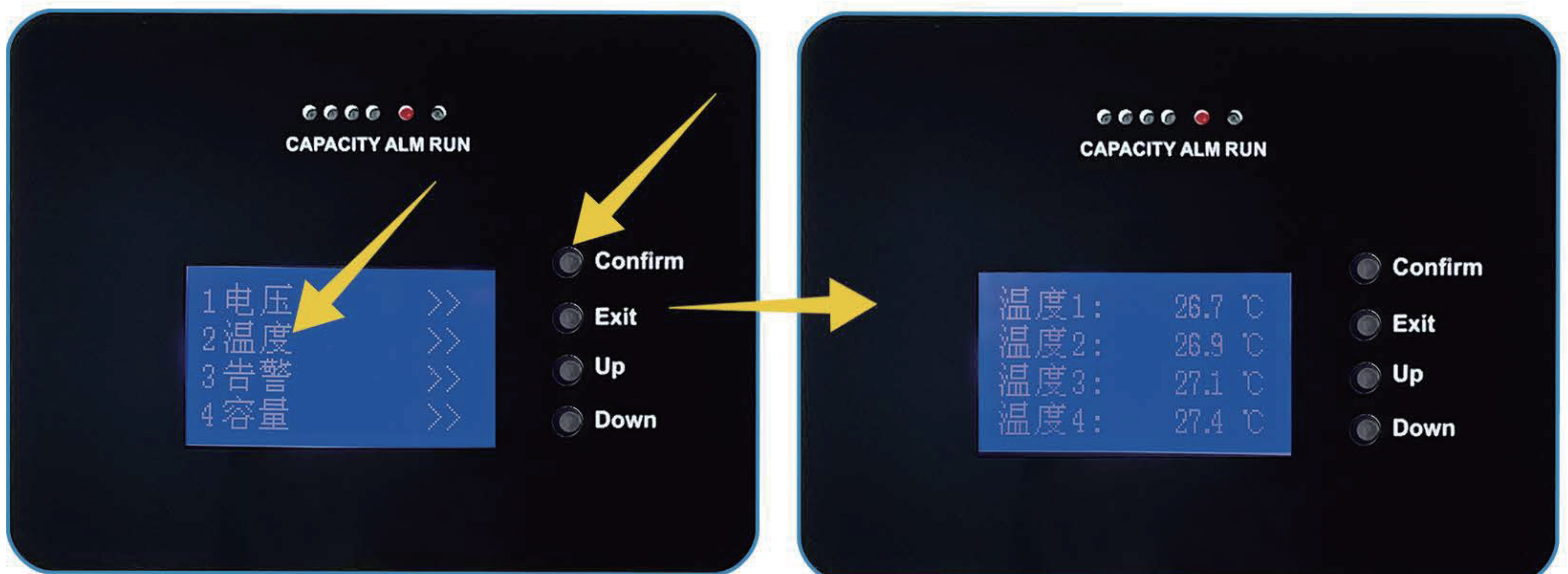

**3.选择“温度” 点击“confirm” 进入**

# CONNECTION DIAGRAM

## English ④

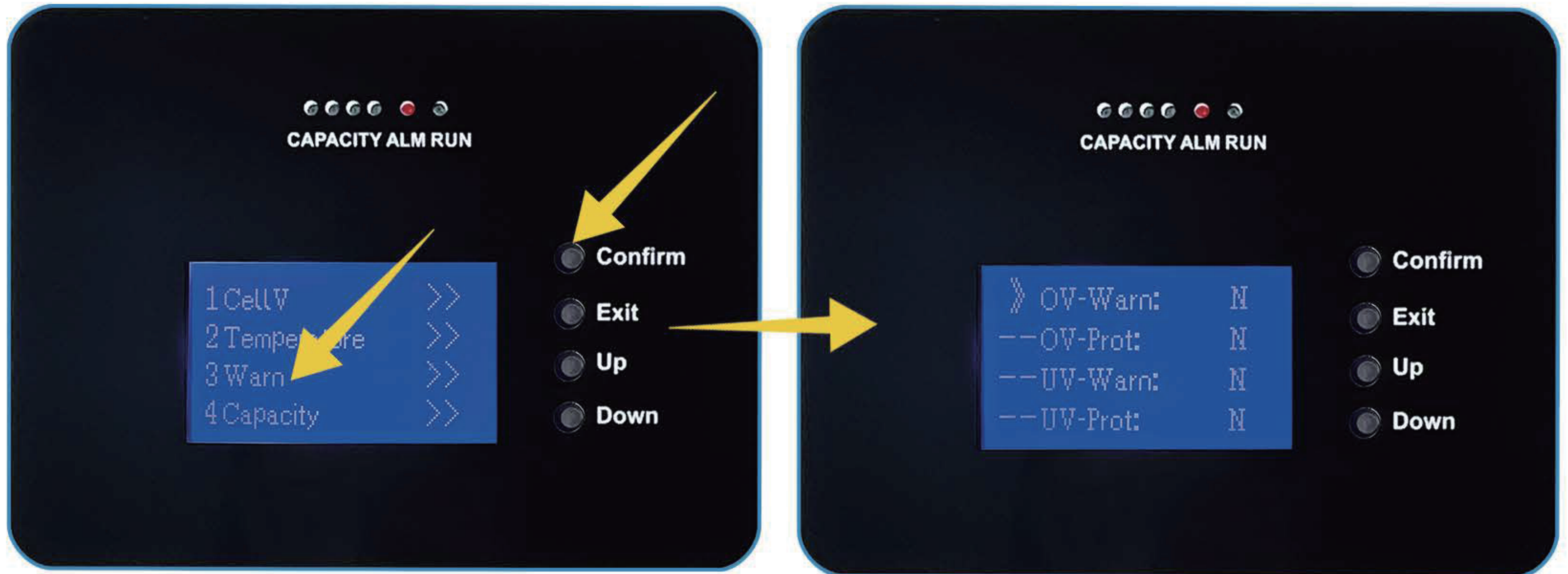

4. Select "Alarm" and click "confirm" to enter

## 中文 ④

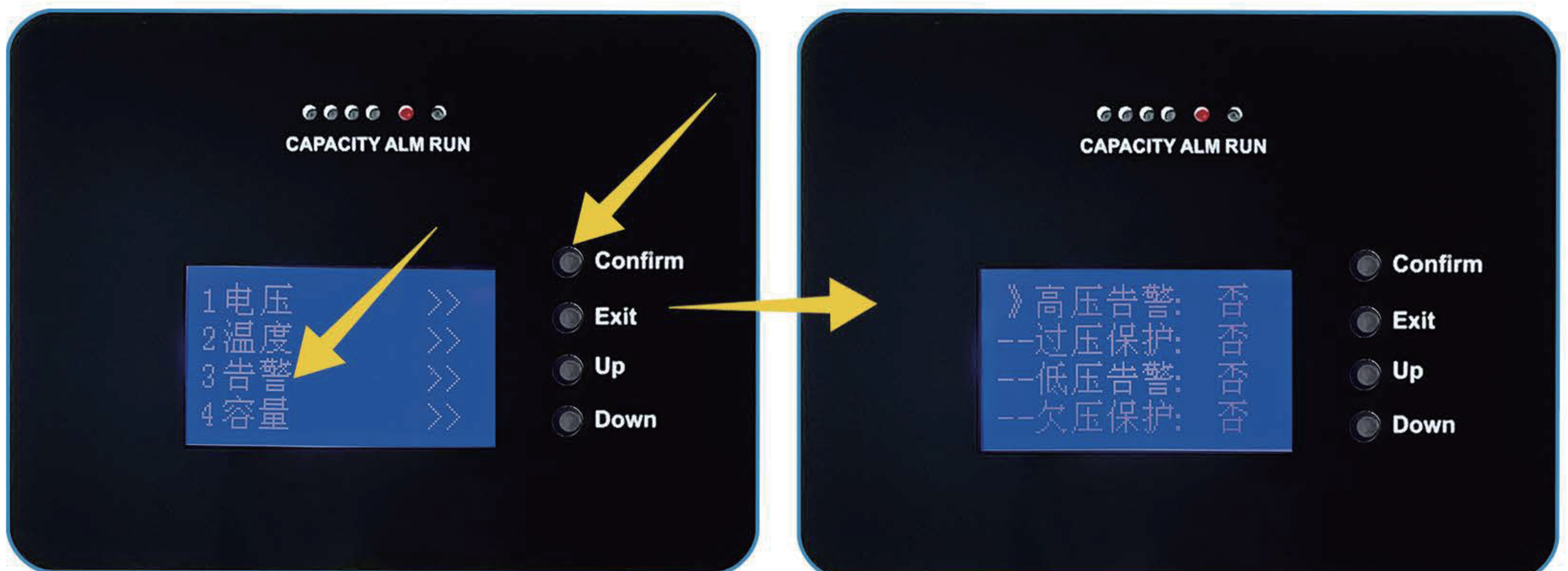

4.选择“告警”点击“confirm”进入

# CONNECTION DIAGRAM

## English ⑤

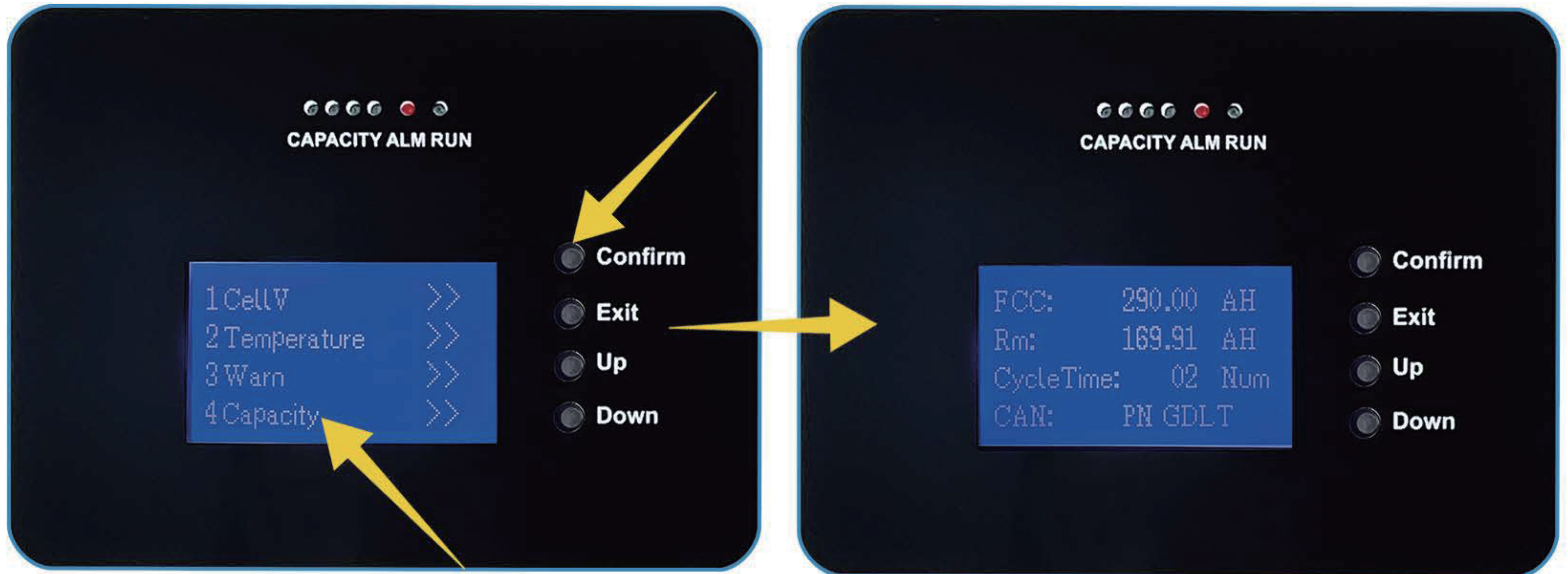

**5. Select "Capacity" and click "confirm" to enter**

## 中文 ⑤



**5. 选择“容量” 点击“confirm” 进入**

# CONNECTION DIAGRAM



IPhone/IOS APP  
Store Search "EN BMS"  
(手机APP下载)

English ①

中文 ①

10:53 0.38 KB/s HD HD 86

Login



please input account

please input password

Login

切换为中文

Account "admin"  
Password "11111"

10:53 1.11 KB/s HD HD 86

登录



请输入账号

请输入密码

登录

Switch to English

登录账号 "admin"  
登录密码: "11111"

# CONNECTION DIAGRAM

## English ②

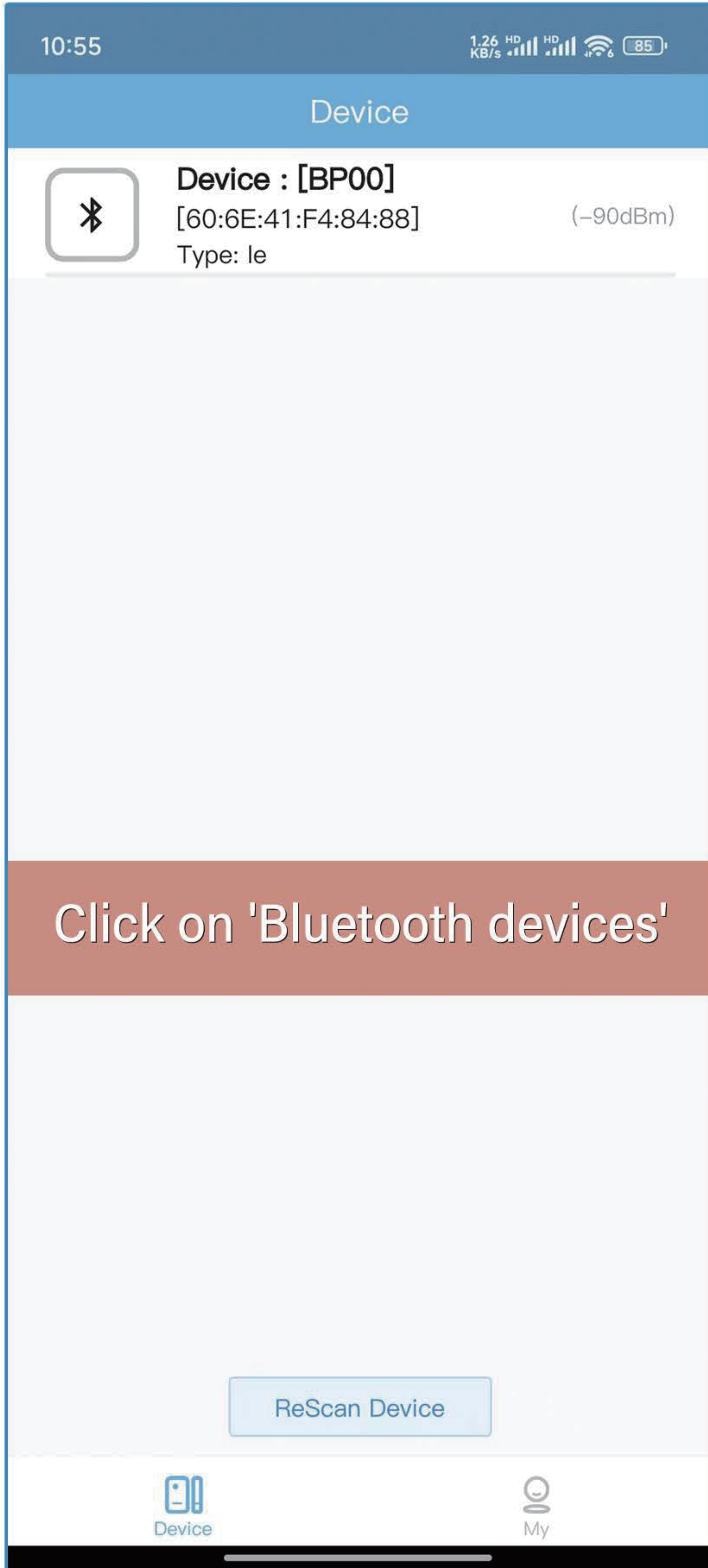

## 中文 ②

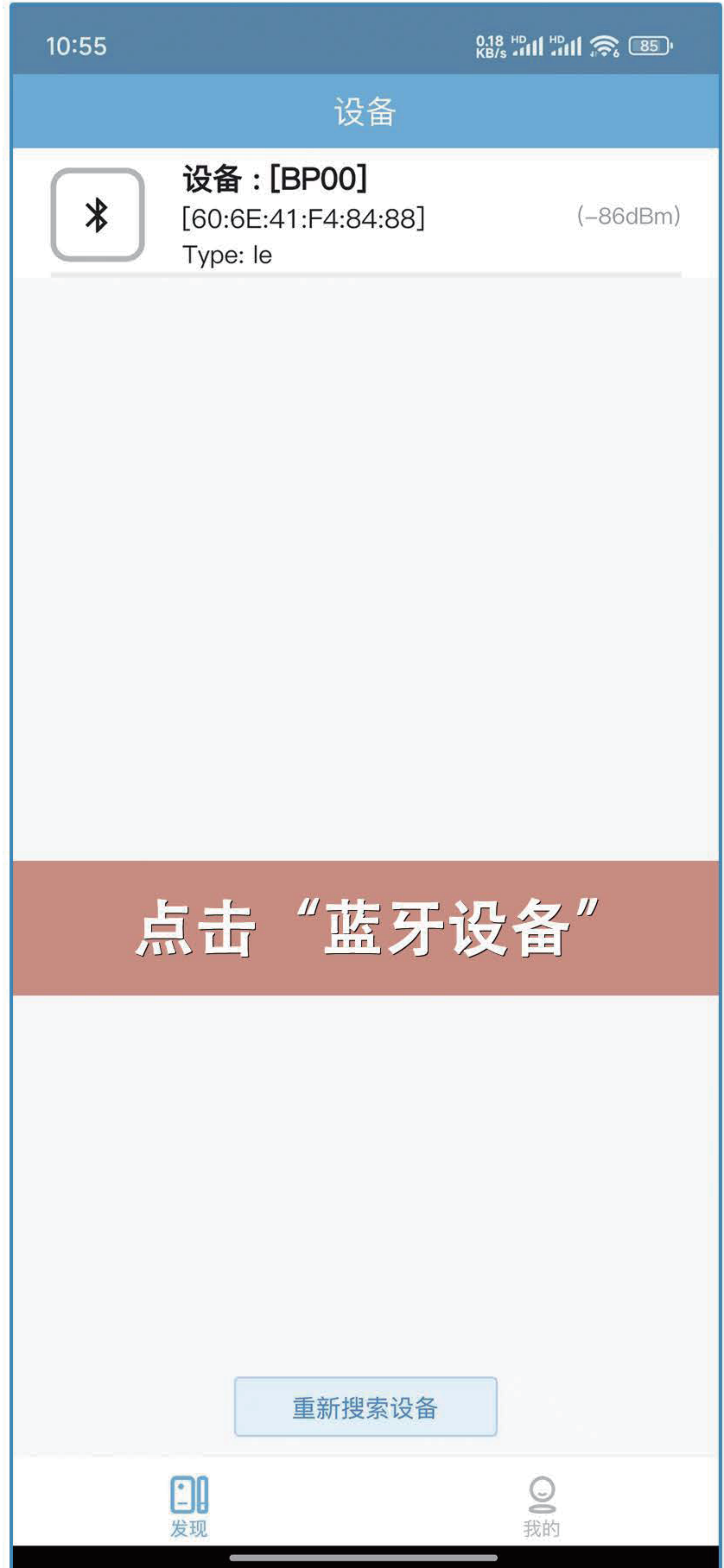

# CONNECTION DIAGRAM

English ②

中文 ②

10:55 2.12 KB/s HD HD 85

BP00

Number Of Strings: 16

SOC: 58.5%

52.90V 0.00A

Remaining Capacity: 169.92Ah

Standby

Alarm: 0 Alarm Info Protection: 0 ...

Battery Type	Rated Capacity	Battery Capacity
LFP	290.0Ah	290.00Ah
Port Voltage	Number Of Cycles	SOH
52.90V	2	100.0%

Click on 'Configure Parameters'

Max	Mini	Max	Mini	Power
Voltage	Voltage	Temperature	Temperature	Temperature
3.309V	3.304V	27.2°C	26.5°C	27.5°C

Inverter CAN PN\_GDLT >

Inverter 485 PN >

Single > Device Detail

Set Param Switch Setting

10:56 2.08 KB/s HD HD 85

BP00

串数: 16

SOC: 58.5%

52.90V 0.00A

剩余容量: 169.92Ah

待机

告警: 0 条告警信息 保护: 0 条保护信息

电池类型	额定容量	电池容量
磷酸铁锂电池 (LFP)	290.0Ah	290.00Ah
端口电压	循环次数	SOH
52.90V	2	100.0%

最高电压 3.309V 最低电压 3.304V 最高温度 27.2°C 最低温度 26.5°C 功率温度 27.5°C

点击“配置参数”

Inverter CAN PN\_GDLT >

Inverter 485 派能 (PN) >

单机 > 设备详情

配置参数 开关设置

# CONNECTION DIAGRAM

## English ②

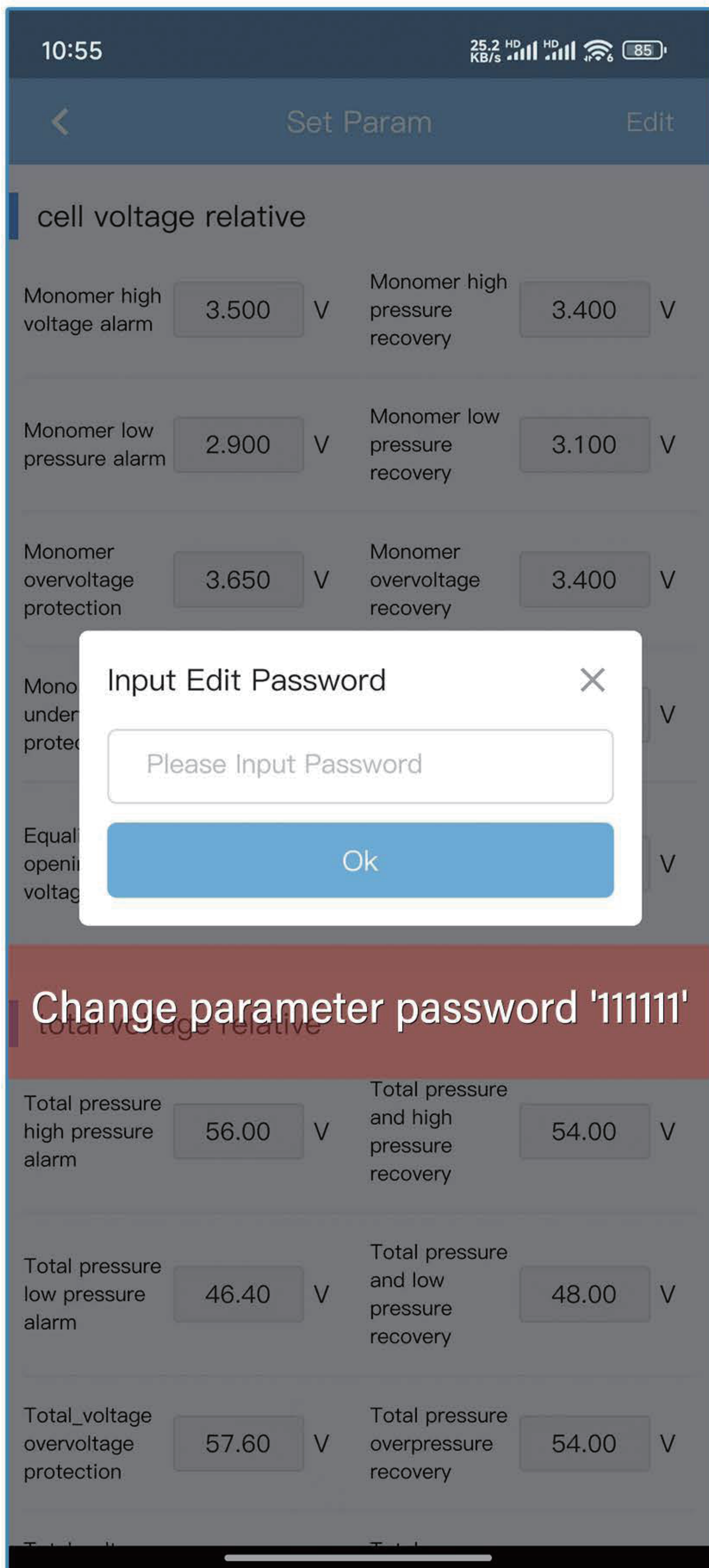

Change parameter password '11111'

## 中文 ②



修改参数密码 "11111"

# PARALLEL OPERATION

Support 16 Packs Max(最多支持16组电池并联)

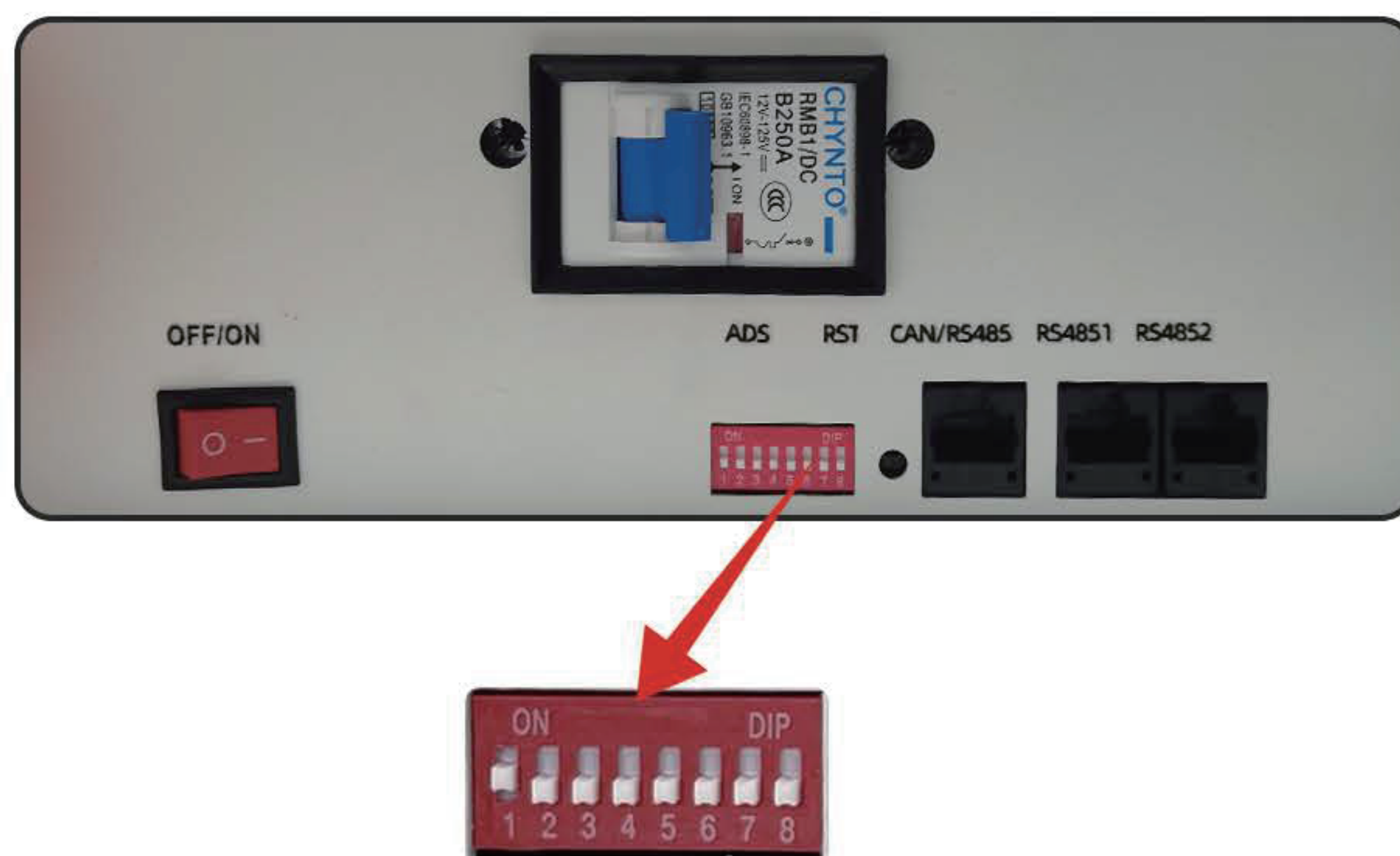

主机设置（表 2）

并机数	拨码开关位置				说明
	#5	#6	#7	#8	
2	ON	OFF	OFF	OFF	2 台并机
3	OFF	ON	OFF	OFF	3 台并机
4	ON	ON	OFF	OFF	4 台并机
5	OFF	OFF	ON	OFF	5 台并机
6	ON	OFF	ON	OFF	6 台并机
7	OFF	ON	ON	OFF	7 台并机
8	ON	ON	ON	OFF	8 台并机
9	OFF	OFF	OFF	ON	9 台并机
10	ON	OFF	OFF	ON	10 台并机
11	OFF	ON	OFF	ON	11 台并机
12	ON	ON	OFF	ON	12 台并机
13	OFF	OFF	ON	ON	13 台并机
14	ON	OFF	ON	ON	14 台并机
15	OFF	ON	ON	ON	15 台并机